

Key Requirements for Sequestr Installation

2019

Click to add Presenter
Month xx, Year



New and Improved Features

- Refer to the installation manual and installation video for detailed installation instructions. This section is meant to highlight key features and knowledge required for selecting and understanding install requirements, but does not contain all information required
- Sequestr was designed with specific features to help with installation
 - Compression Stops



New and Improved Features

- Sequestr was designed with specific features to help with installation
 - Compression Stops
 - Wider ganged opening



New and Improved Features

- Sequestr was designed with specific features to help with installation
 - Compression Stops
 - Wider ganged opening
 - Easier to install interlock



New and Improved Features

- Sequestr was designed with specific features to help with installation
 - Compression Stops
 - Wider ganged opening
 - Easier to install interlock
 - Dovetail Gasket



Determine if an offset is needed

First determine if there is an A dimension offset needed between the main enclosure and Sequestr. An offset may be needed to ensure that the interlock aligns with the disconnect handle when using variable rod, or does not interfere with handle cam when using cable operated.

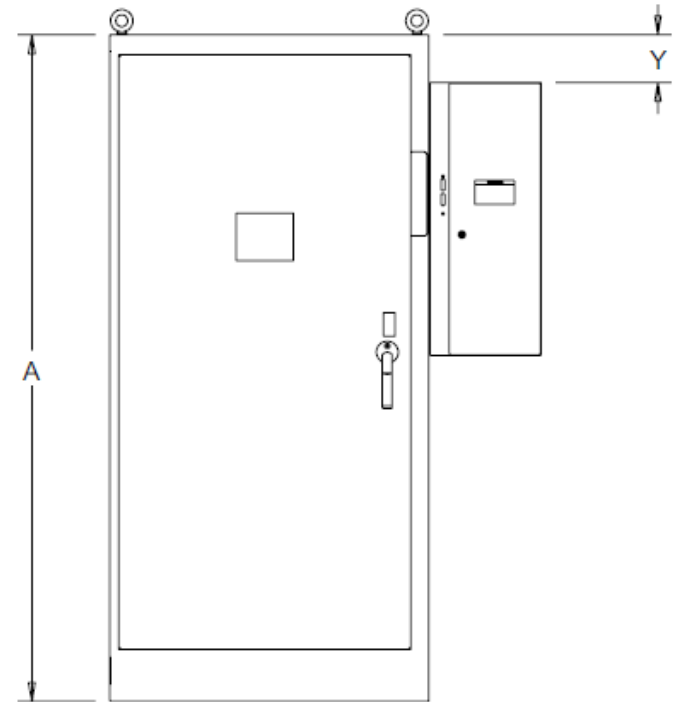

Mild Steel Offset

High AMP Sequestr does not require an offset for models less than 90" tall

The following table shows the offset required for the Low AMP Sequestr

Notice: Variable Rod Disconnects will not work with 60" Tall A21 bulletin due to alignment issues with interlock

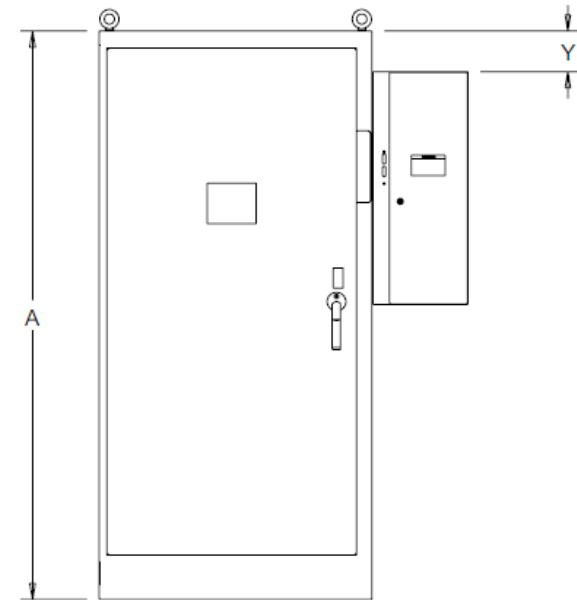

A21 Bulletin

A in.	Variable Rod	Cable	Y in./mm
60	No	Yes	9.50 241
72	Yes	Yes	5.00 127

A28, A34, A4L3D Bulletins

A	Variable Rod	Cable	Y in./mm
72	Yes	Yes	3.00 76
84	Yes	Yes	9.00 229
90	Yes	Yes	12.00 305

Stainless Steel Offset

High AMP Sequestr does not require an offset for models less than 90" tall

The following table shows the offset required for the Low AMP Sequestr

Notice: Variable Rod Disconnects will not work with 60" Tall A21S4 bulletin due to alignment issues with interlock

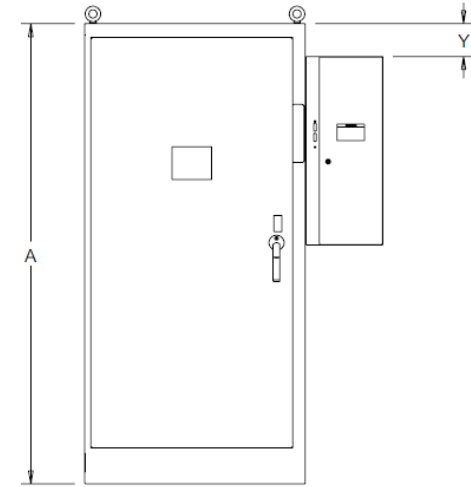

A21S4 Bulletin

A in.	Variable Rod	Cable	Y (n.)	Y mm/in.
60	No	Yes	9.50	241
72	Yes	Yes	5.00	127

A28S4 Bulletin

A in.	Variable Rod	Cable	Y in./mm
72	Yes	Yes	3000 76
84	Yes	Yes	9.00 229
90	Yes	Yes	12.00 305

Use the Correct Template

Once the offset has been determined, use the correct template to measure and drill mounting holes.

There are **5 different templates**, one for each size Sequestr. DXF files are provided so solid templates can be created for higher volume assembly.

Notice: It is critical that the front of Sequestr aligns with the front of the main enclosure to ensure proper interlocking.

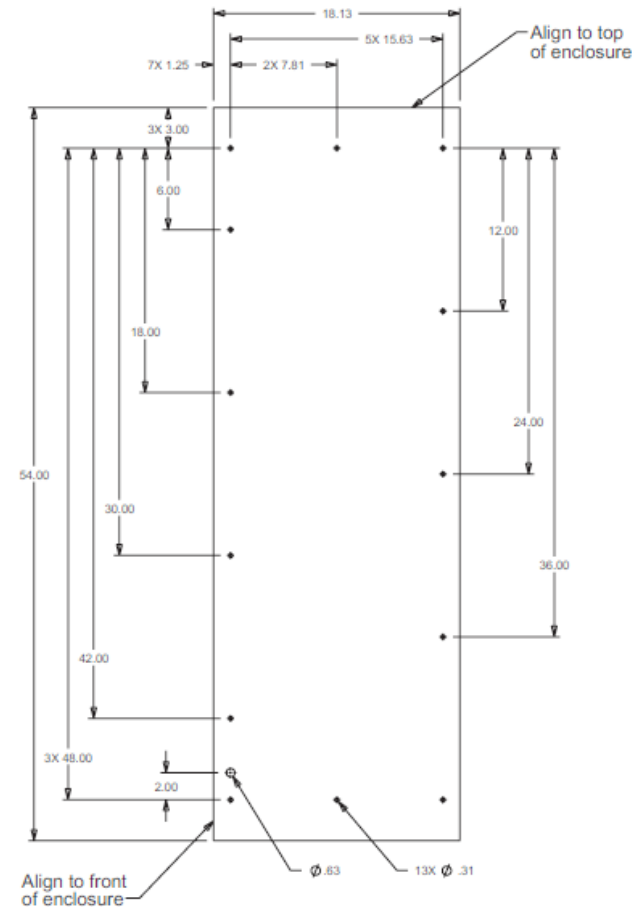

TEMPLATE FOR
54 X 18 SEQUESTR
(1:1 scale downloadable template is
available at nVent/hoffman.com)

Creating Pass Throughs to Main Enclosure

- Power and other components (potentially the disconnect handle for cable operated devices) need to be routed to main enclosure. When routing components, it is critical that live components are not exposed on the other side or are shielded to ensure accidental contact is not possible. It is up to the customer to ensure this happens since we have no control on how they modify or install components in the enclosure
- **NFPA 79E Section 6.2.3 States:**
 - Direct Contact from Outside an Enclosure. Equipment enclosures and enclosure openings shall meet the requirements of ANSI/UL 508, UL 508A, ANSI/UL 50, or NEMA 250. (See Figure 6.2.3.) Exception: In the absence of a rated enclosure, the determination of the suitability of an enclosure as protection from electrical shock shall be determined by using a test finger as described in Figure 6.2.3. The test finger shall be applied, with only minimal force, in every opening in the enclosure after removal of all parts of the enclosure that are capable of being removed without the use of

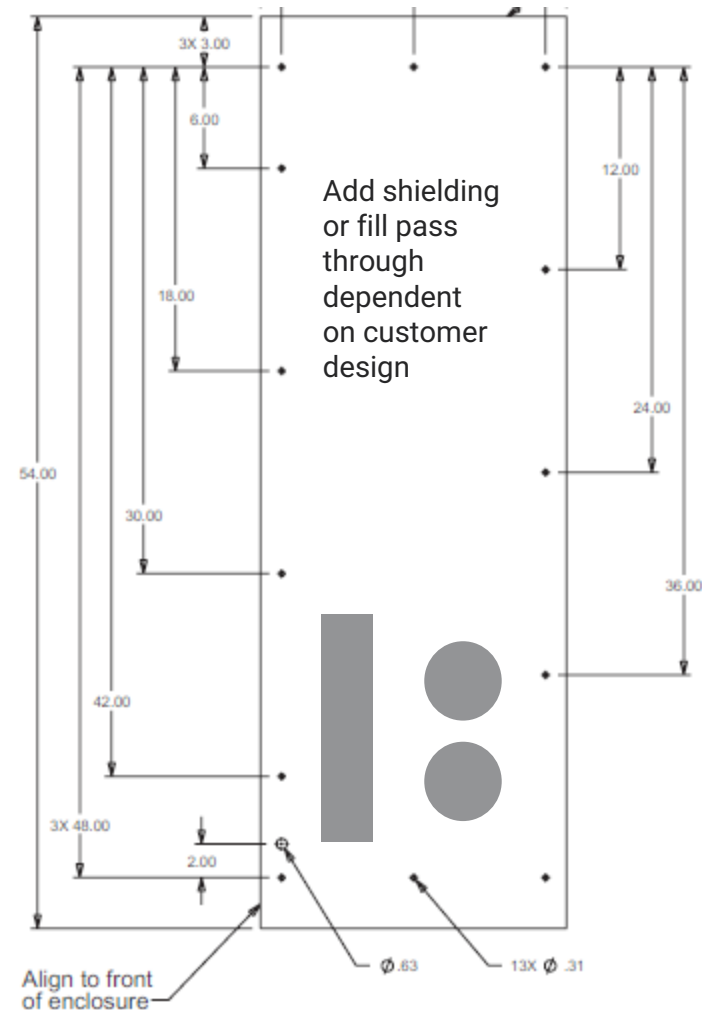

Interlock and Disconnect

- Consult HOFFMAN's Sequestr Manuals and relevant Disconnect Manufacturers Manual for proper disconnect installation.
- The interlock operates by door activation (open or closed) and is independent of disconnect handle position. Therefore it is critical that the door hook properly aligns with disconnect handle defeater to ensure proper operation.
- When disconnect handle is mounted in Sequestr the defeater mechanism of the handle goes through the main enclosure side to engage the door hook.
- When the disconnect handle is mounted in the main enclosure, it operates the same as a normal disconnect enclosure with the addition of the door to door interlock on Sequestr.

Thank you

